



# BRASSELER USA<sup>®</sup>

QUARTERLY  
PROMOTIONS

## SMART Rewards

*Make it Count with Your Next Order!*



Enroll now at

***Shop.BrasselerUSA.com/  
SmartRewards***

to unlock exclusive, members-only  
savings when you purchase the  
quality dental essentials you trust.



**APRIL-  
JUNE 2023**

# INTRODUCING THE BRASSELER USA Preparation-To-Polish Restorative System

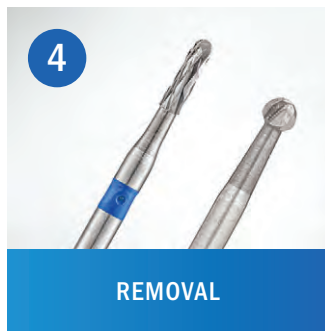



# DIGITAL X-RAY SENSORS

You know when something is *just right*

- ▶ **PATIENT COMFORT**  
Clipped corners provide a gentler fit
- ▶ **DURABILITY**  
Durable enough to handle all your operatory activities
- ▶ **IMAGE CLARITY**  
Technology designed to produce crystal clear images
- ▶ **PLUG & PLAY**  
Hands-off integration with most practice management platforms



### GEM™ Sensor Kit

- 1 GEM Digital X-Ray Sensor
- 100 GEM Sensor Barriers
- 1 Positioning System

Retail: \$6,995.00



(Sensors shown at actual size)

Product		GEM10	GEM15	GEM20
Order No.		5028383U0	5028384U0	5028385U0
Sensor Technology		CMOS		
External Dimensions (mm)	L	36.36	38.83	41.80
	W	24.53	29.63	30.48
	H	12.52	13.01	13.02
Active Imaging Area (mm)		30.01 x 20.01	32.99 x 25.82	35.92 x 25.82
Active Image Area (px)		1539 x 1026	1692 x 1324	1842 x 1324
Image Resolution		20+ visible lp/mm		
Image Pixel Size		19.5 x 19.5 µm		
Maximum Gray Levels		16,384 (14 bit)		
Cable Length		1.9m		





**BLU Microlaser Starter Kit**

- 1 BLU microlaser
- 2 Lithium-ion batteries
- 1 Wireless foot pedal
- 2 AA batteries for foot pedal
- 1 Base charger
- 1 Power supply
- 10 Disposable tips (5 each: 5mm, 7mm)
- 3 Pairs of safety glasses
- 1 Pack of Initiating paper

Retail: \$6,495.00

**Special: \$5,525.00**

# DIAGNOSTIC INSTRUMENTS

**Buy 24 Instruments, Get 45% Off!\***

**Buy 12 Instruments, Get 35% Off!\***

**Buy 6 Instruments, Get 25% Off!\***



**EX23/CP12P Expro**

N33 · Explorer 23



**EX5 Explorer**

Combination of Explorer 23 and 17



**DP100**

Dressing Pliers



**FSCS5/1**  
#5 Mirror

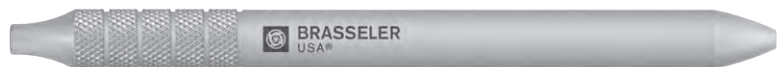

**MH6CS**

Lightweight ergonomic  
mirror handle

*\*Mix and match*

# RESTORATIVE MATERIALS

## DualForce™ Matrix System Complete Kit 209022-B

Retail: \$571.99

**Special: \$428.99**

1	Premolar Ring	20	#1 Active-Wedges
1	Molar Ring	20	#2 Active-Wedges
25	Ultra-Wrap Matrix Bands, 4.5mm	20	#3 Active-Wedges
25	Ultra-Wrap Matrix Bands, 5.5mm	20	#4 Active-Wedges
25	Ultra-Wrap Matrix Bands, 6.5mm	20	#5 Active-Wedges
1	Band Punch Pliers		
1	Ring Forceps		



## G5™ All-Purpose Desensitizer

- Eliminates post-operative sensitivity in posterior composite restorations
- Works by coagulating plasma proteins within dentinal tubule fluid, which helps eliminate movement of the fluid—the root cause of dentinal sensitivity
- Used after Max Etch and before MPa Max adhesive

### 5mL Bottle 226105-B

Retail: \$88.99 ea.

**Buy 2 5mL Bottles of Desensitizer, Get 1 5mL Bottle at No Additional Cost!**

### 10mL Bottle 226110-B

Retail: \$127.99 ea.

**Buy 2 10mL Bottles of Desensitizer, Get 1 10mL Bottle at No Additional Cost!**



## Accur8™ Dual-Arch Impression Posterior Trays 50-Pack

**047501-B**

Retail: \$124.99

**Buy 2 Packs, Get 1 at No Additional Cost!**

# DIRECT RESTORATION

Brasseler USA's recommended diamonds, carbides, and polishers for each step of a Direct Restoration.

## COMPOSITE

### Amalgam Removal Diamond



Us No.	—
Order No.	<b>6813</b>
Head Size (1/10 mm)	014
Cutting Length (mm)	1.5
Grit	
Shank Type	FG

### Amalgam Removal Carbides



Sabrecut®		
Us No.	—	<b>1558SC</b>
Order No.	<b>H34</b>	<b>H031RS</b>
Head Size (1/10 mm)	010	012
Cutting Length (mm)	2.0	4.0
Blade		—
Shank Type	FG	FG

### Composite Removal Diamonds



ET® Series		
Us No.	—	<b>DET6F</b>
Order No.	<b>6830</b>	<b>134F</b>
Head Size (1/10 mm)	014	014
Cutting Length (mm)	2.7	6.0
Grit		
Shank Type	FG	FG

### Decay Removal Carbide



Us No.	<b>4</b>
Order No.	<b>H1</b>
Head Size (1/10 mm)	014
Cutting Length (mm)	—
Blade	—
Shank Type	RA

### Preparation Diamonds



Micro			
Us No.	<b>330D</b>	<b>557D</b>	—
Order No.	<b>D232</b>	<b>D835</b>	<b>838M</b>
Head Size (1/10 mm)	008	010	007
Cutting Length (mm)	2.0	4.2	2.5
Grit			
Shank Type	FG	FG	FG

### Preparation Carbides



C-Series™					
Us No.	<b>4C</b>	<b>35C</b>	<b>245C</b>	<b>330C</b>	<b>557C</b>
Order No.	<b>H1</b>	<b>H2</b>	<b>H245</b>	<b>H7</b>	<b>H31</b>
Head Size (1/10 mm)	014	010	008	008	010
Cutting Length (mm)	—	0.9	2.8	2.0	3.9
Blade	—	—	—	—	—
Shank Type	FG	FG	FG	FG	FG

### Finishing Diamonds



ET® Series					
Us No.	<b>DET6F</b>	<b>DET9F</b>	—	<b>DOS1F</b>	—
Order No.	<b>134F</b>	<b>135F</b>	<b>8888</b>	<b>8379</b>	<b>8392</b>
Head Size (1/10 mm)	014	014	012	023	016
Cutting Length (mm)	6.0	9.0	8.0	4.2	5.0
Grit					
Shank Type	FG	FG	FG	FG	FG

### Finishing Carbides



ET® Series Safe-End					
Us No.	<b>ET6</b>	<b>ET9</b>	<b>7901</b>	—	<b>7408/OS1</b>
Order No.	<b>H134</b>	<b>H135</b>	<b>H246</b>	<b>H274</b>	<b>H379</b>
Head Size (1/10 mm)	014	014	009	016	023
Cutting Length (mm)	6.0	9.0	3.6	3.5	4.2
Blade					
Shank Type	FG	FG	FG	FG	FG

**Buy 20 Packs, Get 40% Off!\***  
**Buy 10 Packs, Get 30% Off!\***  
**Buy 5 Packs, Get 20% Off!\***

### FINISHING CARBIDE BLADE CONFIGURATION

12 Blade

### DIAMOND GRIT SIZE

Coarse

Medium

Fine

\*Mix and match

# DIRECT RESTORATION



## Diamond Finishing Strips

	Order No.	Width (mm)	Length (mm)	Grit	Single/Double Sided
VisionFlex™	WS25A	2.5	147	Yellow Red Blue Asst. (EF, F, M)	Single
Gateway™	DS25A	2.5	147	Yellow Red Blue Asst. (EF, F, M)	Single

Buy 20 Packs,  
Get 40% Off!\*

Buy 10 Packs,  
Get 30% Off!\*

Buy 5 Packs,  
Get 20% Off!\*



## Separating Strip

Order No.	Thickness (mm)	Width (mm)	Length (mm)
9816	0.05	6.0	150

Buy 20 Packs, Get 40% Off!  
Buy 10 Packs, Get 30% Off!  
Buy 5 Packs, Get 20% Off!

## Universal Composite Polishers



	BrioShine™ Single-Patient Sterile				EP™	Versaflex™	Composipro™
Order No.	SFLBCO-1	SBFLCP-CO	SFLBF-2	SBFLCP-F	EP1SM	VFD1LG	D209001
Head Size (1/10 mm)	100	055	100	055	80	120	060
Shape	Feather Lite™	Feather Lite™ Cup	Feather Lite™	Feather Lite™ Cup	Pop-On Disc	Snap-On Disc	Brush
Grit	Medium	Medium	Fine	Fine	C, M, F, XF	SC, C, M, F	Medium/Fine
Shank Type	RA	RA	RA	RA	EPM21 Mandrel	310.21 Mandrel	RA



	Diacomp® Multi-Use			
Order No.	FLDC5M	DC3M.21	FLDC5	DC3.21
Head Size (1/10 mm)	140	060	140	060
Cutting Length (mm)	1.6	7.5	1.6	7.5
Shape	Feather Lite™	Cup	Feather Lite™	Cup
Grit	Medium	Medium	Fine	Fine
Shank Type	RA	RA	RA	RA

Buy 15 Packs, Get 40% Off! \*  
Buy 10 Packs, Get 30% Off! \*  
Buy 5 Packs, Get 20% Off! \*

\*Mix and match

## LOW SPEED HANDPIECES

### Electric



**Forza™ Pro 1:1 Latch**  
Retail: \$1,479.00  
Special: \$1,257.15

Buy 2 at Special Price, Get 1 at No Additional Cost!

Mix and match. Must be of equal or lesser value.

### Air



**Forza™ LS-BR Latch**  
Retail: \$519.00

Buy 3, Get 1 at No Additional Cost!

Mix and match. Must be of equal or lesser value.

# INDIRECT RESTORATION

Brasseler USA's recommended diamonds, carbides, and polishers for each step of Crown & Bridge Restorations.

Buy 20 Packs, Get 40% Off! \*  
Buy 10 Packs, Get 30% Off! \*  
Buy 5 Packs, Get 20% Off! \*

## CROWN REMOVAL

### Porcelain, Zirconia, & Lithium Disilicate Removal Diamond



DuraCut™

Order No.	6856DC
Head Size (1/10 mm)	016
Cutting Length (mm)	8.0
Grit	
Shank Type	FG

### PFM, Metal Substructure Cutting Carbides



Order No.	H34L
Head Size (1/10 mm)	012
Cutting Length (mm)	3.5
Blade	
Shank Type	RA

### Depth Cutting Diamonds



Order No.	Winter Restorative Concepts				
	WDLCONV	WDLEXT	WDL1.0	WDL1.5	WDL2.0
Head Size (1/10 mm)	030	034	016	017	017
Depth Cut (mm)	0.5 / 0.7 / 0.9	0.8 / 1.0 / 1.2	1.0	1.5	2.0
Grit					
Shank Type	FG	FG	FG	FG	FG

### Breaking Contact Diamonds

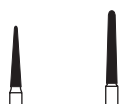

Order No.	5858	5850
Head Size (1/10 mm)	014	012
Cutting Length (mm)	8.0	10.0
Grit		
Shank Type	FG	FG

### Occlusal/Lingual Reduction Diamonds



Order No.	5379	5811
Head Size (1/10 mm)	023	033
Cutting Length (mm)	4.2	4.2
Grit		
Shank Type	FG	FG

### Margin Refinement Diamonds

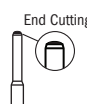

Order No.	Winter Restorative Concepts
	WSMR1.0
Head Size (1/10 mm)	010
Cutting Length (mm)	0.27
Tip Size (1/10 mm)	1.0
Grit	
Shank Type	FG

### Preparation Diamonds



Order No.	Winter Restorative Concepts Multi-Radius					KS Series				
	WS6M1.0	WS6M1.2	WS8M0.6	WS8M1.0	WS8M1.2	KS0	KS1	KS2	KS3	KS6
Head Size (1/10 mm)	016	018	014	018	020	010	012	014	016	025
Cutting Length (mm)	6.0	6.0	8.0	8.0	8.0	7.0	7.0	8.0	8.0	9.0
Tip Size (1/10 mm)	1.0	1.2	0.6	1.0	1.2	-	-	-	-	-
Grit										
Shank Type	FG	FG	FG	FG	FG	FG	FG	FG	FG	FG

### Preparation Diamonds

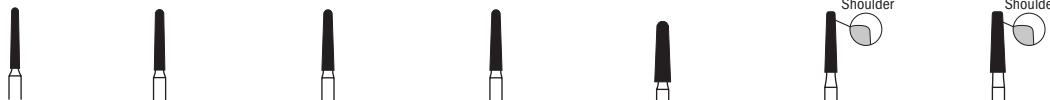

Order No.	856	856	856	856	856	847KR	847KR
Head Size (1/10 mm)	012	014	016	018	021	016	018
Cutting Length (mm)	8.0	8.0	8.0	8.0	8.0	8.0	8.0
Grit							
Shank Type	FG	FG	FG	FG	FG	FG	FG

\*Mix and match



# SPECIALTY RESTORATION

## LAMINATE VENEER

Buy 20 Packs, Get 40% Off! \*  
Buy 10 Packs, Get 30% Off! \*  
Buy 5 Packs, Get 20% Off! \*

### Depth Cutting Diamonds

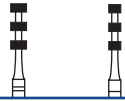

US No.	LVS1	LVS2
Order No.	834	834
Head Size (1/10 mm)	021	016
Cutting Length (mm)	6.0	6.0
Depth Cut (mm)	0.5	0.3
Grit		
Shank Type	FG	FG

### Preparation Diamonds

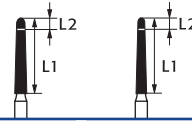

US No.	LVS3	LVS4
Order No.	6844	6844
Head Size (1/10 mm)	016	014
Cutting Length (mm)	10.0/1.5	10.0/1.5
Depth Cut (mm)	—	—
Grit	Coarse/Fine	Coarse/Fine
Shank Type	FG	FG

## INLAY/ONLAY

### Preparation Diamonds



Order No.	845KR	845KR
Head Size (1/10 mm)	018	025
Cutting Length (mm)	4.0	4.0
Grit		
Shank Type	FG	FG

## PERI-IMPLANTITIS

Developed with Dr. Dennis Tarnow and Dr. Paul Rosen for treatment of peri-implantitis

### NEW! TR™ C-Series™ Carbides

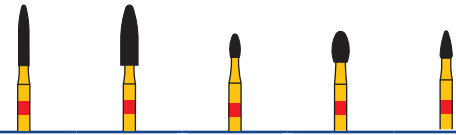

Order No.	TR1	TR2	TR3	TR4	TR5
Head Size (1/10 mm)	014	023	014	023	016
Cutting Length (mm)	8.0	8.0	3.1	4.1	3.5
Blade					
Shank Type	XL FG Surg	XL FG Surg	XL FG Surg	XL FG Surg	XL FG Surg

### FINISHING CARBIDE BLADE CONFIGURATION

- 12 Blade
- 30 Blade

### DIAMOND GRIT SIZE

- DuraCut™ (DC)
- Super-Coarse
- Coarse
- Medium
- Fine

\*Mix and match

## HIGH SPEED HANDPIECES

### Electric



**Forza™ Pro 1:1 FG**  
Retail: \$1,479.00  
Special: \$1,257.15



**Forza™ Pro 1:5 FG**  
Retail: \$1,699.00  
Special: \$1,444.15

### Air



**Brio550L**  
Retail: \$999.00  
Special: \$799.20

Buy 2 at Special Price, Get 1 at No Additional Cost!  
*Mix and match. Must be of equal or lesser value.*

# INDIRECT RESTORATION

## INTRA-ORAL ADJUSTING & POLISHING OF ALL CERAMIC MATERIALS

### Adjusting Stone



#### LD Grinder™

Order No.	LD11CZR
Head Size (1/10 mm)	030
Cutting Length (mm)	7.5
Qty/Pack	5
Grit	Coarse
Shank Type	RA

### LD Grinder™ Point

Retail: \$98.75/Pk

**Special: \$74.06/Pk**

### Adjusting Diamonds

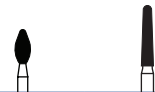

#### Dialite®

Order No.	8369DF	8856DF
Head Size (1/10 mm)	025	016
Cutting Length (mm)	5.5	8.0
Grit	●	●
Shank Type	FG	FG

**Buy 20 Packs, Get 40% Off!\***

**Buy 10 Packs, Get 30% Off!\***

**Buy 5 Packs, Get 20% Off!\***

### Dialite® Intra-Oral Polishers

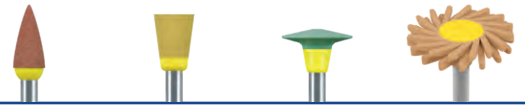

Order No.	W16	W17	W18	FLW14
Head Size (1/10 mm)	040	060	100	140
Cutting Length (mm)	10.0	7.5	2.5	1.6
Qty/Pack	5	5	5	3

21 - RA - Right-Angle Latch (22 mm)

#### Porcelain

● Coarse	W16DCHP21	W17DCHP21	W18DCHP21	FLW14C.RA
● Medium	W16DMHP21	W17DMHP21	W18DMHP21	FLW14M.RA
● Fine	W16DFHP21	W17DFHP21	W18DFHP21	FLW14FERA

#### Zirconia

● Medium	W16MZR.RA	W17MZR.RA	W18MZR.RA	FLW14MZR.RA
● Fine	W16FZR.RA	W17FZR.RA	W18FZR.RA	FLW14FZR.RA

#### Lithium Disilicate

● Medium	W16MLD.RA	W17MLD.RA	W18MLD.RA	FLW14MLD.RA
● Fine	W16FLD.RA	W17FLD.RA	W18FLD.RA	FLW14FLD.RA

Recommended Speed for Points, Cups & Knife Edge: 5,000-7,000 rpm

Recommended Speed for Feather Lite: 4,000-6,000 rpm; Final Polish: 2,000-3,000 rpm

### Intra-Oral Dialite® Points, Cups, & Knife-Edge Polishers

Retail: \$86.50/Pk

### Intra-Oral Dialite® Feather Lite™ Polishers

Retail: \$68.10/Pk

**Buy 15 Packs, Get 40% Off!\***

**Buy 10 Packs, Get 30% Off!\***

**Buy 5 Packs, Get 20% Off!\***

### Sterile Universal Ceramic Polishers



Order No.	SBPT	SBCP	SFLB	SBFLCP
Head Size (1/10 mm)	040	060	100	055
Qty/Pack	25	25	25	25

21 - RA - Right-Angle Latch (22 mm)

● Medium	SBPTCER-1	SBCPCER-1	SFLBCER-1	SBFLCP-CE
● Fine	SBPTF-2	SBCPF-2	SFLBF-2	SBFLCP-F

Recommended Speed: 4,000-6,000 rpm; Final Polish: 2,000-3,000 rpm

**Buy 15 Packs, Get 40% Off!\***

**Buy 10 Packs, Get 30% Off!\***

**Buy 5 Packs, Get 20% Off!\***

### Sterile BrioShine™ Points & Cups

Retail: \$88.45/Pk

### Sterile BrioShine™ Feather Lite™

Retail: \$115.65/Pk

### Sterile BrioShine™ Feather Lite™ Cups

Retail: \$95.10/Pk

#### DIAMOND GRIT SIZE

● Fine

\*Mix and match

# EXTRA-ORAL ADJUSTING & POLISHING OF ALL CERAMIC MATERIALS

## Adjusting Stones



Order No.	LD13	LD14	LD15
Head Size (1/10 mm)	040	050	150
Cutting Length (mm)	10.0	13.0	3.0
Grit	Coarse, Medium	Coarse, Medium	Coarse, Medium
Shape	Flat-End Taper	Cylinder	Wheel
Shank Type	HP	HP	HP

## LD Grinder™ Taper

Retail: \$33.80 ea.

**Special: \$25.35 ea.**

## LD Grinder™ Cylinder

Retail: \$47.55 ea.

**Special: \$35.67 ea.**

## LD Grinder™ Wheel

Retail: \$60.85 ea.

**Special: \$46.74 ea.**

## Dialite® Extra-Oral Polishers



Order No.	H2	R17	R20	L26	FL26
Head Size (1/10 mm)	040	170	200	260	260
Cutting Length (mm)	13.0	2.5	3.0	2.0	1.6
Qty/Pack	1	1	1	1	1

11 - HP - Straight Handpiece (44.5 mm)

### Porcelain

Coarse	H2DCHP	R17DCHP	—	L26DCHR11	FL26CHP
Medium	H2DMHP	R17DMHP	—	L26DMHR11	FL26MHP
Fine	H2DFHP	R17DFHP	—	L26DFHR11	FL26FHP

### Zirconia

Medium	H2MZR.HP	R17MZR.HP	R20MZR.HP	L26MZR.HP	FL26MZR.HP
Fine	H2FZR.HP	R17FZR.HP	R20FZR.HP	L26FZR.HP	FL26FZR.HP

### Lithium Disilicate

Medium	H2MLD.HP	R17MLD.HP	R20MLD.HP	L26MLD.HP	FL26MLD.HP
Fine	H2FLD.HP	R17FLD.HP	R20FLD.HP	L26FLD.HP	FL26FLD.HP

Recommended Speed for Points, Wheel & Knife Edge: 8,000-10,000 rpm

Recommended Speed for Feather Lite: 4,000-10,000 rpm; Final Polish: 2,000-5,000 rpm

## Extra-Oral Dialite® Points

Retail: \$32.40 ea.

**Buy 15 Packs, Get 40% Off!\***

**Buy 10 Packs, Get 30% Off!\***

**Buy 5 Packs, Get 20% Off!\***

## Extra-Oral Dialite® Small Wheel Polishers

Retail: \$58.15 ea.

## Extra-Oral Dialite® Knife-Edge Polishers

Retail: \$82.70 ea.

## Extra-Oral Dialite® Large Wheel & Feather Lite™ Polishers

Retail: \$64.80 ea.

\*Mix and match

## STRAIGHT HANDPIECES

### Electric



### Forza™ F1S

Retail: \$799.00

**Special: \$719.10**

**Buy 2 at Special Price, Get 1 at No Additional Cost!**

*Mix and match. Must be of equal or lesser value.*

### Air



### Forza™ LS Straight Nosecone

Retail: \$479.00

**Buy 3, Get 1 at No Additional Cost!**

*Mix and match. Must be of equal or lesser value.*

# ESR™ CM RECIPROCATING FILES

ESR CM utilizes the latest NiTi technology to provide clinicians with superior safety, efficiency and performance. ESR CM files are also designed to preserve more coronal tooth structure compared to WaveOne® Gold.

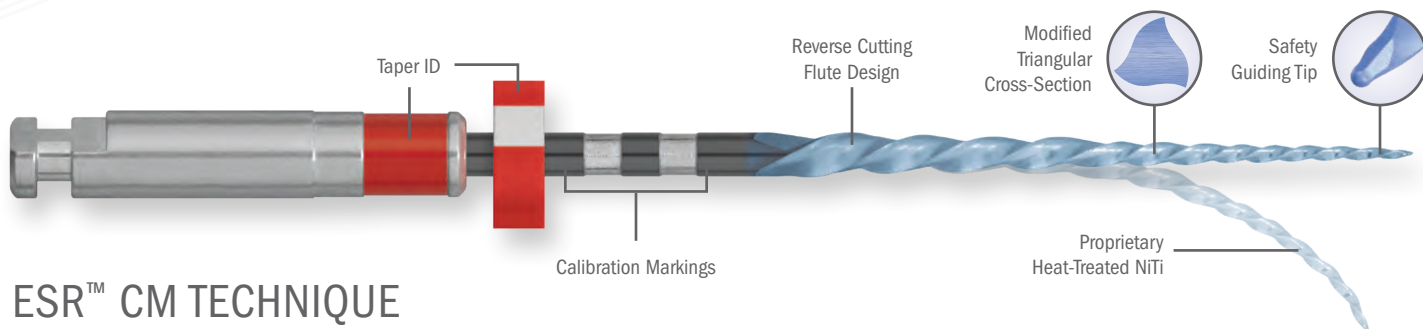

## ESR™ CM TECHNIQUE

1. After straight line access, determine working length (WL) with a size #10 K-file.
2. Use the ESR CM #25 primary/gauging file to estimate the canal size by engaging in three light strokes.
  - a. If the file reaches the apex easily the canal is “Basic” (larger) and you should finish with the Large ESR CM #40 or Extra-Large ESR CM #50 file.
  - b. If the ESR CM #25 does not reach the apex after two series of three light strokes the canal is “Advanced” (tighter) and you need to use a #15 K-file or the ESR CM Scout file to reestablish a safe glidepath to WL. Next, finish with an ESR CM #30 (which actually has a smaller max diameter than the #25). For extremely tight canals consider finishing with the Small ESR CM #20.
3. Obturate with BC Sealer™ and the matching BC Points™ for the last file used to reach WL.

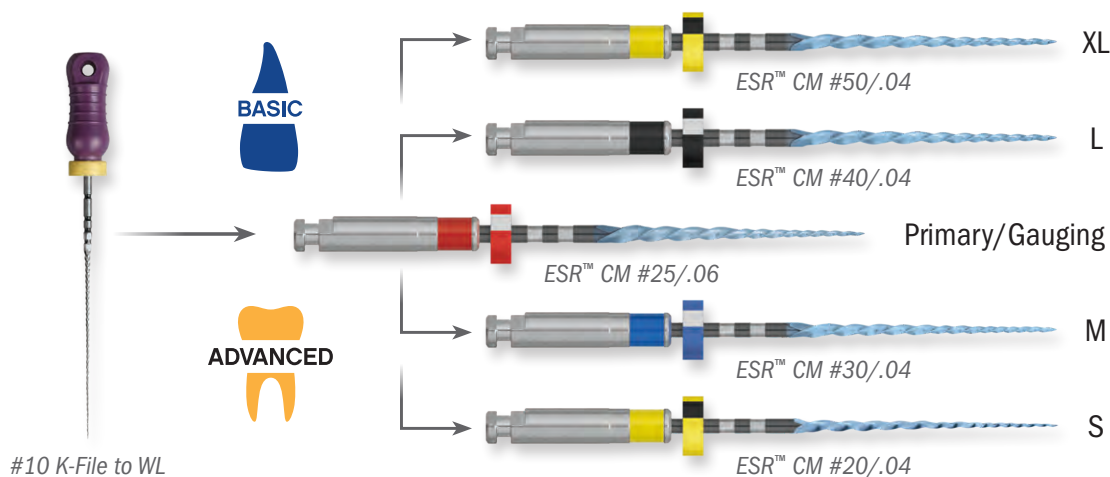

ESR CM files are provided in sterile blister packs for optimal convenience and safety. If sterility is compromised prior to treatment, the files can be sterilized without any loss of functionality or performance.

STERILE	R	File/Tip ID	Tip Size	21 mm	25 mm	31 mm
△	White	15C*	5029334U0	5029335U0	5029336U0	
△	White	15	5028076U0	5028084U0	5028092U0	
△	Yellow	20	5029126U0	5029127U0	5029128U0	
△	Red	25	5028078U0	5028086U0	5028094U0	
△	Blue	30	5028079U0	5028087U0	5028095U0	
△	Black	40	5028081U0	5028089U0	5028097U0	
△	Yellow	50	5028082U0	5028090U0	5028098U0	

### ESR™ CM Files (3/Pack)

**Buy 50 Packs, Get 40% Off!**  
**Buy 25 Packs, Get 25% Off!**  
**Buy 10 Packs, Get 15% Off!**

*Mix and match*

*\*15C scout file uses a different austenite metallurgy, making it more robust in tight/curved canals.*



# NEW! XP-3D SHAPER+

Brasseler USA's next generation adaptive file designed to streamline your procedures and give you greater control and safety. With a new, improved ShaperTip, this file allows for more efficient navigation, making it easier to guide around curves and keeping it centered in the canal.

ORIGINAL XP-3D BOOSTER TIP  
3 Facets

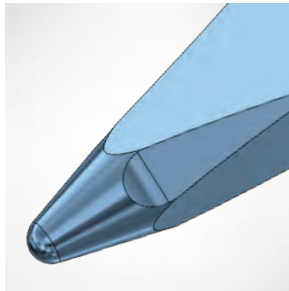

XP-3D SHAPER+ IMPROVED TIP  
6 Facets

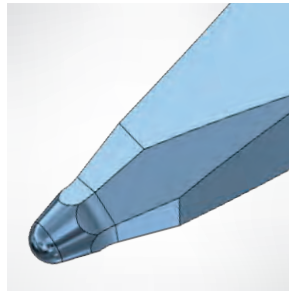

The XP-3D Shaper+ features Adaptive Core Technology, which enables the central core of the file to move freely and adapt to the natural morphology of the canal. This helps with debris removal, making the process more efficient without occluding dental tubules. Additionally, the turbulence generated by the XP-3D Shaper+ enhances the penetration of irrigants into the dentinal tubules, improving overall disinfection of the canal.

TRADITIONAL  
CORE FILES

Debris Accumulation/Compaction

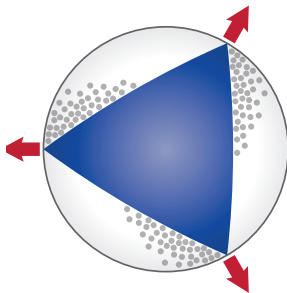

XP-3D SHAPER+  
ADAPTIVE CORE

Free-Floating with Turbulence

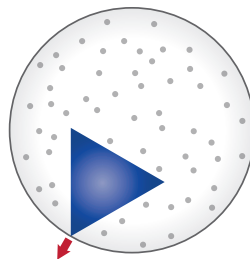

● Debris  
● Stress applied to the canal wall

Using the XP-3D Shaper+ can help reduce debris accumulation and compaction, while also reducing the stress applied to the canal wall. This innovative file transitions from ISO #15 to ISO #30, allowing for shorter procedure times and greater agility.

Experience the new design of the XP-3D Shaper+, which offers greater predictability, simplicity, and control. Discover the benefits of the next generation adaptive file, and take your procedures to the next level.

## XP-3D™ Shaper+ (3/Pack)

Retail: \$85.50/Pk

**Special: \$59.85/Pk**

File/Tip ID	Tip Size	21 mm (Stopper)	25 mm (Stopper)	31 mm (Stopper)
▲ Blue	30	5028597U0	5028598U0	5028599U0

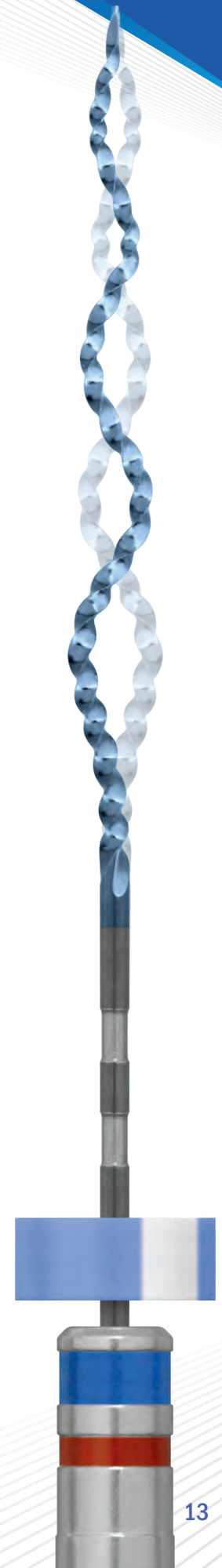

# TRITON<sup>®</sup>

## ALL-IN-ONE IRRIGATION SOLUTION

Unlike traditional irrigants or other advanced 2:1 solutions, Triton works differently by avoiding the use of EDTA and CHX altogether. The non-NaOCl components in Triton proactively dissolve the dentinal debris allowing for a lower concentration of NaOCl to be exposed to organic debris without as much buffering. Synergistic and simultaneous dissolution of organic and inorganic debris permits the clinician to use lower volumes of irrigation solution and ensure maximum clinical efficiency.

### TRITON VS. TRADITIONAL IRRIGATION

- ✓ Multi-functional single irrigation solution reduces chair time, procedural steps, and overall irrigation costs
- ✓ Simultaneous organic and inorganic debris removal
- ✓ Patent-pending composition allows for a lower concentration of NaOCl to be used while providing improved efficacy
- ✓ More effective at smear layer removal vs. NaOCl with EDTA
- ✓ Dissolves organic tissue up to 1.7x faster than traditional NaOCl

### COST-EFFECTIVE

Not only will Triton reduce chair time by eliminating the need for multiple irrigation solutions and sterile water rinses, but it also reduces the number of single-use disposable syringes and tips you'll require. In some cases, Triton can cut your total irrigation cost per procedure in half.



Retail: \$199.95  
**Special: \$149.97**



## BC SEALER™ IS TURNING 15!

15 years of clinical success,  
and there's so much  
to celebrate!

**EndoSequence™ BC Sealer™**

- 1 2g Syringe
- 15 BC Tips™
- 1 Safety Data Sheet (SDS)

Retail: \$200.00

**Special Birthday Promotion: \$128.88**  
**PLUS Take 35% Off all Other Bioceramic Products**  
*Use Promo Code: BCBDAY*

# TotalVac™ IRRIGATION SYSTEM

TotalVac addresses the negative and positive pressure suction and irrigation needs of clinicians performing root canal therapy procedures. The design allows for single-handed positive pressure irrigation with simultaneous suction. The TotalVac kit can be configured to perform both positive and negative pressure irrigation using the included tips, which vary in length and diameter.

TotalVac is a highly modular system which allows versatility and access to a multitude of needles of different lengths and diameters, based on your specific needs.

## TotalVac™ Kit

- 25 High Volume Evacuation and Surgical Suction Adaptor
- 25 TotalVac Tubing
- 25 Plastic Suction Tip
- 25 25 Gauge Short Delivery Tip
- 25 30 Gauge Side Vented Long Delivery Tip



Retail: \$200.00  
**Special: \$163.00**

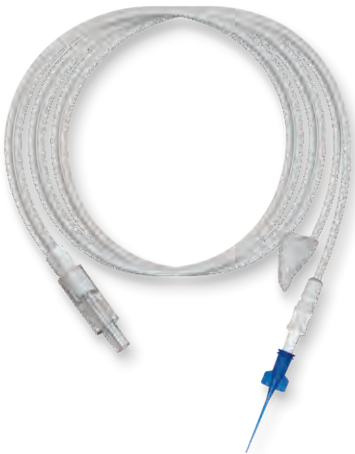

## TotalVac™ Tubing (20/Pack)

Retail: \$100.00/Pk  
**Special: \$85.00/Pk**

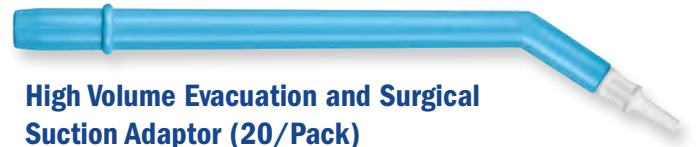

## High Volume Evacuation and Surgical Suction Adaptor (20/Pack)

Retail: \$37.50/Pk  
**Special: \$31.88/Pk**



## 25GA Short Irrigation Tip (20/Pack)

Retail: \$18.00/Pk  
**Special: \$15.30/Pk**



## Triton & TotalVac Kit Bundle

**\$312.00**

(Retail Value: \$399.95)

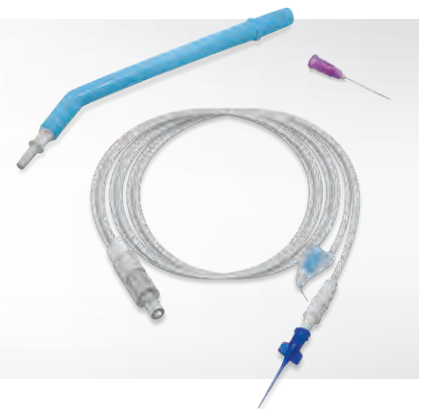

Visit [BrasselerUSADental.com/Discover-TotalVac](http://BrasselerUSADental.com/Discover-TotalVac) to read an article and watch an instructional video presented by Dr. Allen Ali Nasseh, DDS, MMSc





# FORZA PRO

Introducing Brasseler's Forza Pro series. This line of premium electric attachments includes a 1:5 High Speed, 1:1 Latch and new 1:1 FG, ideal for margin refinement! The Forza Pro series features a scratch-resistant, glass coating, improving both aesthetics and durability. The heat-blocking technology of the ceramic ball bearing design helps to minimize the risk of patient burns. Forza Pro also offers the longest warranty in the industry at 3 years!



**Buy 2 Attachments at Special Price,  
Get 1 Attachment at No Additional Cost!**

*Mix and match. Must be of equal or lesser value.*

- ▶ Compatible with all E-Type Electric Motors
- ▶ Scratch-Resistant Glass Coating
- ▶ 5-Port Water Spray
- ▶ Heat Blocker Technology
- ▶ Small Head Size
- ▶ 3-Year Warranty



### Forza™ Pro 1:5

- Fiber Optic
- Head size: 14.5mm x 9.5mm
- 3-Year Warranty

Retail: \$1,679.00

**Special: \$1,511.10**



### Forza™ Pro 1:1 Latch

- Fiber Optic
- Head size: 12.4mm x 9.5mm
- 3-Year Warranty

Retail: \$1,449.00

**Special: \$1,304.10**



### Forza™ Pro 1:1 FG

- Fiber Optic
- Head size: 13.8mm x 9.5mm
- 3-Year Warranty

Retail: \$1,449.00

**Special: \$1,304.10**



# FORZA™ LS LOW SPEED SYSTEM

The Forza LS low speed handpiece series from Brasseler USA features a convenient Quick Coupler design which converts all Forza LS air motors into quick disconnect devices. The series offers durable, single-piece construction attachments and powerful air motors for all major low speed brands: KaVo®, Midwest®, NSK®, Star®, and W&H®.

**Upgrade your Operatory for the price of one competitor motor!**

**1 Quick Coupler, 2 Motors\*, 2 Attachments\***

**\$1,679.00 (Retail Value: \$2,595.00)**

*\*Mix and match. Must be of equal or lesser value.*

Variety of Models  
Compatible With All Major  
Low Speed Brands

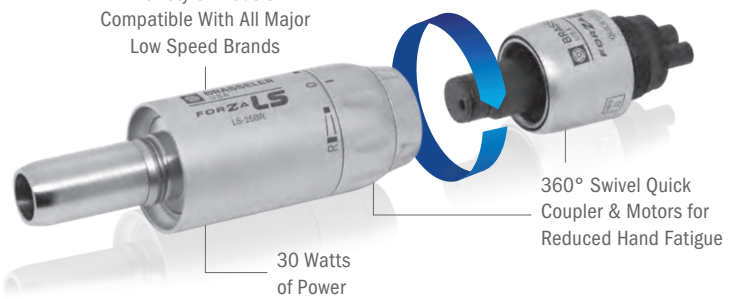

## BRASSLER & NSK® (E-TYPE) COMPATIBLE



**LS-25BR**  
Retail: \$679.00



**LS-BR Latch**  
Retail: \$519.00



**LS-BR FG**  
Retail: \$519.00



**LS-BR Straight**  
Retail: \$479.00

## STAR® COMPATIBLE



**LS-25ST** Retail: \$779.00



**LS-ST Latch**  
Retail: \$519.00



**LS-ST FG**  
Retail: \$519.00



**LS-ST Straight**  
Retail: \$479.00



**LS-5ST** Retail: \$779.00

## MIDWEST® COMPATIBLE



**LS-25MW** Retail: \$779.00



**LS-MW Latch**  
Retail: \$519.00



**LS-MW FG**  
Retail: \$519.00



**LS-5MW** Retail: \$779.00



**LS-MW Straight**  
Retail: \$479.00

**Buy 3 Motors,  
Get 1 Motor &  
1 Coupler at No  
Additional Cost!**

*Mix and match. Must be of  
equal or lesser value.*



**Quick Coupler**  
Retail: \$199.00

**Buy 3  
Attachments,  
Get 1 Attachment  
at No Additional  
Cost!**

*Mix and match. Must be of  
equal or lesser value.*

*KaVo® is a registered trademark of Kaltenbach & Voigt GmbH, Germany. Midwest® is a registered trademark of DENTSPLY International. NSK® is a registered trademark of Nakanishi, Inc. Star® is a registered trademark of DentalEZ, Inc. W&H® is a registered trademark of W&H Dentalwerk Bürmoos GmbH, Austria.*

# FORZA™ ELXT ELECTRIC MOTOR



- ▶ Most powerful micromotor at an incredible 4.2 Ncm of torque! Nearly 30% more power than the industry average!\*
- ▶ Reduced Risk of Patient Burns with the advanced Safety Check Function
- ▶ Low Cost, Hassle-free installation with the unique split-module space saving design
- ▶ Lightweight and compact motor provides optimal balance and comfort

\*Data on file.

## Forza™ ELXT

- LED Fiber Optics
- Torque: 4.2 Ncm
- Speed Range: 100-200,000 rpm
- Motor Weight: 59g
- 3-Year Warranty

Retail: \$3,349.00

**Forza Electric Package:**  
**1 Forza ELXT and**  
**Any 3 Forza Electric**  
**Attachments\***  
**\$4,599.00**  
 (Retail Value: \$8,446.00)



\*Mix and match

Set Also Includes: Mounting Bracket for PC Box, PC Box, Power Cord, AC Adapter (120V)

# FORZA™ SHORT SERIES ELECTRIC ATTACHMENTS

## Forza™ M5

- 1:5 Speed Increasing
- Fiber Optic
- 10,000-200,000 rpm
- For Friction Grip Burs
- 3-Year Warranty

Retail: \$1,699.00

**Special: \$1,529.10**

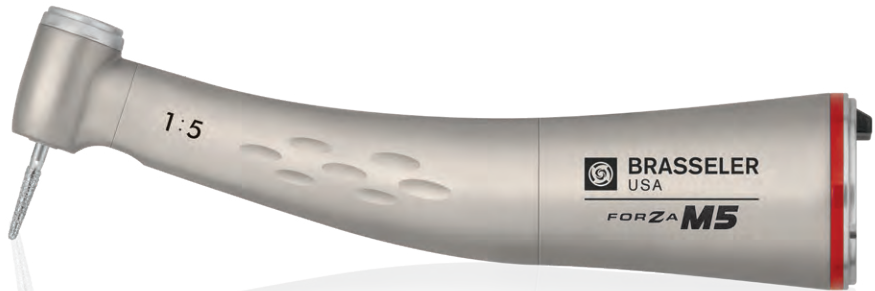

## Forza™ M1

- 1:1 Gear Ratio
- Fiber Optic
- 2,000-40,000 rpm
- For Latch Type Burs
- 3-Year Warranty

Retail: \$1,479.00

**Special: \$1,331.10**

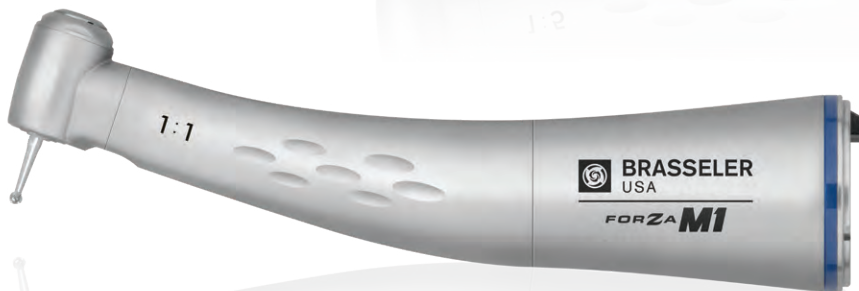

**Buy 2 Attachments at Special Price, Get 1 Attachment at No Additional Cost!**

*Mix and match. Must be of equal or lesser value.*

### SHORTER LENGTH



85 mm

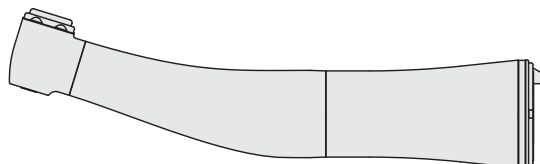

96 mm

### Forza™ M5

### Average Electric Attachment Size

### SMALLER HEAD & NECK

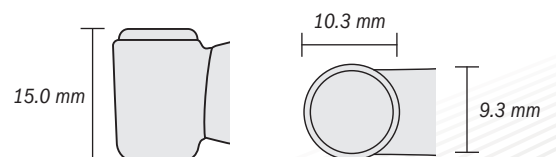
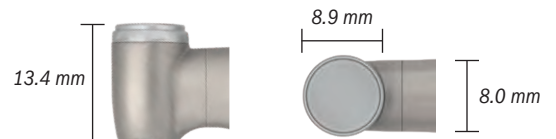



# BRASSELER U.S.A. DENTAL, LLC

One Brasseler Blvd.  
Savannah, GA 31419

Toll Free: 800.841.4522  
Phone: 912.925.8525  
Fax: 888.610.1937

Shop.BrasselerUSA.com



©2023 Brasseler USA. All rights reserved. Printed in the U.S.A.



# BRASSELER

USA® BY YOUR SIDE

B-5720-US-72M-04.23-RRD



# BRASSELER USA®

TRUST BRASSELER USA FOR FAST, ECONOMICAL  
REPAIR OF YOUR HANDPIECES

We Service All Major Handpiece Brands including:  
A-dec®/W&H®, Bien-Air®, KaVo®, Midwest®, NSK®, Star®

**HANDPIECE  
REPAIR** X

- ▶ QUALITY
- ▶ GREAT PRICE
- ▶ FAST TURNAROUND

Not sure if we can repair your handpiece? Contact your sales representative  
or contact Brasseler USA directly! 1.800.841.4522 (ext. 4675)

A-dec® is a registered trademark of A-dec, Inc., USA. Bien-Air® is a registered trademark of Bien-Air Medical Technologies, Switzerland.  
KaVo® is a registered trademark of Kaltenbach & Voigt GmbH, Germany. Midwest® is a registered trademark of DENTSPLY International.  
NSK® is a registered trademark of Nakanishi, Inc. Star® is a registered trademark of DentalEZ, Inc.  
W&H® is a registered trademark of W&H Dentalwerk Bürmoos GmbH, Austria.

Invoice or statement prices may reflect or be subjected to a bundled discount or rebate pursuant to purchase offer, promotion, or discount program. You must fully and accurately report to Medicare, Medicaid, Tricare and/or any other federal or State program, upon request by such program, the discounted price(s) or net price(s) for each invoiced item, after giving effect to any applicable discounts or rebates, which price(s) may differ from the extended prices set forth on your invoice. Accordingly, you should retain your invoice and all relevant information for your records. It is your responsibility to review any agreements or other documents, including offers or promotions, applicable to the invoiced products/prices to determine if your purchase(s) are subject to a bundled discount or rebate. Any such discounts must be calculated pursuant to the terms of the applicable purchase offer, promotion, or discount program. Participation in a promotional discount program is only permissible in accordance with discount program rules. By participation in such program, you agree that, to your knowledge, your practice complies with the discount program requirements.

